



**Legends Golf Grill  
& Banquet Facility**

The decor at **Legends Golf Grill** is a tribute to the game of golf and those who made the game what it is today.

Our **MAIN ROOM** offers several seating configurations for groups of varying sizes and needs.

In addition, we have a **BANQUET ROOM** and two outside, second level deck areas.

The various set ups our rooms offer are titled in recognition of the traditional names of golf clubs that we now refer to by more modern names.

**BULGER ROOM**

Our Main Room used in its' entirety, seating up to 160 comfortably. Bulger was the name for the convex shaped wooden driver when first introduced in the 1890's.

**BRASSIE ROOM**

Using approximately 2/3 of our Main Room, the Brassie will accommodate up to 100 in comfort. Brassie was a traditional 4 or 5 wood

**MASHIE ROOM**

Our separate Banquet Room can seat up to 80 comfortably for a meal. Mashie - a 5 iron

**DUPLEX ROOM**

Our Main Room has a moveable wall that can separate a private area for up to 32 people with deck access. Duplex - a small, two way chipper or dual purpose club of the early 1900's - some with different lofts on each side.

**NIBLICK DECK**

Our open aired deck seats up to 50 with a great view of the first tee and warm up putting green. Niblick - an 8 or 9 iron

**LOFTER DECK**

Our covered deck area seats up to 28 in a beautiful, shaded setting. Lofter - what we now call a wedge

**MASHIE ROOM**

(our separate banquet room)

**MEETING SET UP**

Example of **MEETING STYLE** set up for 24-30 people

Room can be set up **SEMINAR STYLE** for up to 120.

Room can be set up **CLASSROOM STYLE** for up to 46.

Room can be set up for a **MEAL FUNCTION** for up to 80.



Entry doors & washroom access

**BBQ**  
w/ pass through

A buffet can be set up in this area

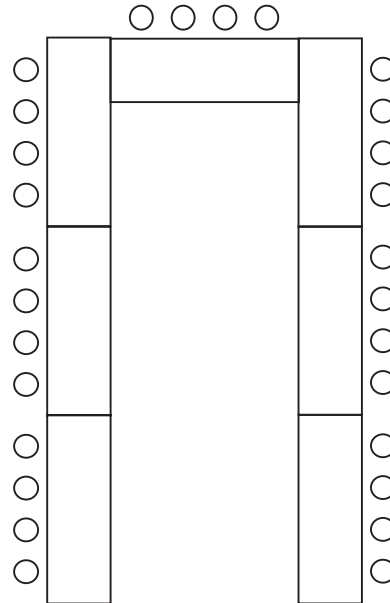

Windows along this wall

Overhead Projection Screen

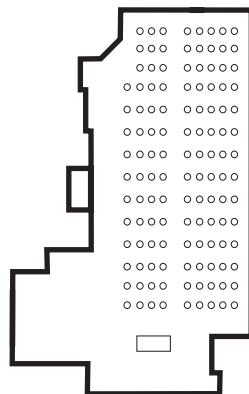

**Seminar Style**

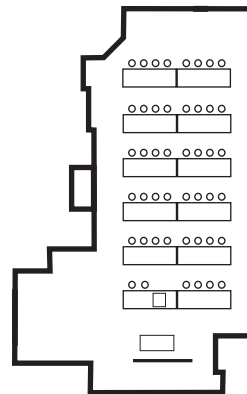

**Classroom Style**

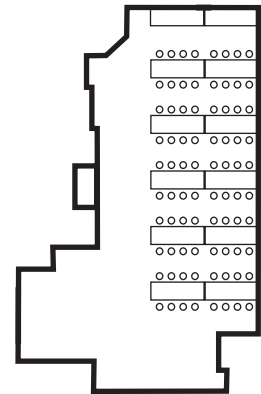

**Meal Function Style**



**(250) 765-4653 GOLF**  
[www.KelownaSprings.com](http://www.KelownaSprings.com)





## Legends Golf Grill & Banquet Facility

The decor at **Legends Golf Grill** is a tribute to the game of golf and those who made the game what it is today.

Our **MAIN ROOM** offers several seating configurations for groups of varying sizes and needs.

In addition, we have a **BANQUET ROOM** and two outside, second level deck areas.

The various set ups our rooms offer are titled in recognition of the traditional names of golf clubs that we now refer to by more modern names.

### BULGER ROOM

Our Main Room used in its' entirety, seating up to 160 comfortably. Bulger was the name for the convex shaped wooden driver when first introduced in the 1890's.

### BRASSIE ROOM

Using approximately 2/3 of our Main Room, the Brassie will accommodate up to 100 in comfort. Brassie was a traditional 4 or 5 wood

### MASHIE ROOM

Our separate Banquet Room can seat up to 80 comfortably for a meal. Mashie - a 5 iron

### DUPLEX ROOM

Our Main Room has a moveable wall that can separate a private area for up to 32 people with deck access. Duplex - a small, two way chipper or dual purpose club of the early 1900's - some with different lofts on each side.

### NIBLICK DECK

Our open aired deck seats up to 50 with a great view of the first tee and warm up putting green. Niblick - an 8 or 9 iron

### LOFTER DECK

Our covered deck area seats up to 28 in a beautiful, shaded setting. Lofter - what we now call a wedge

# BULGER ROOM

(our main room fully set)



Our main room has **MANY** set up possibilities.

In this example, virtually all of the main room space is used. Suitable for up to 160 in a spacious setting.

Option

**NIBLICK DECK** - room for up to 48N

Superb view of the golf course from all windows and decks along this side of room

Sunday Brunch buffet - can be used for lighted prize table

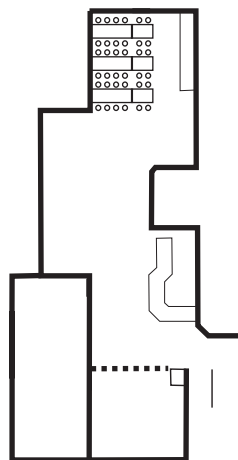
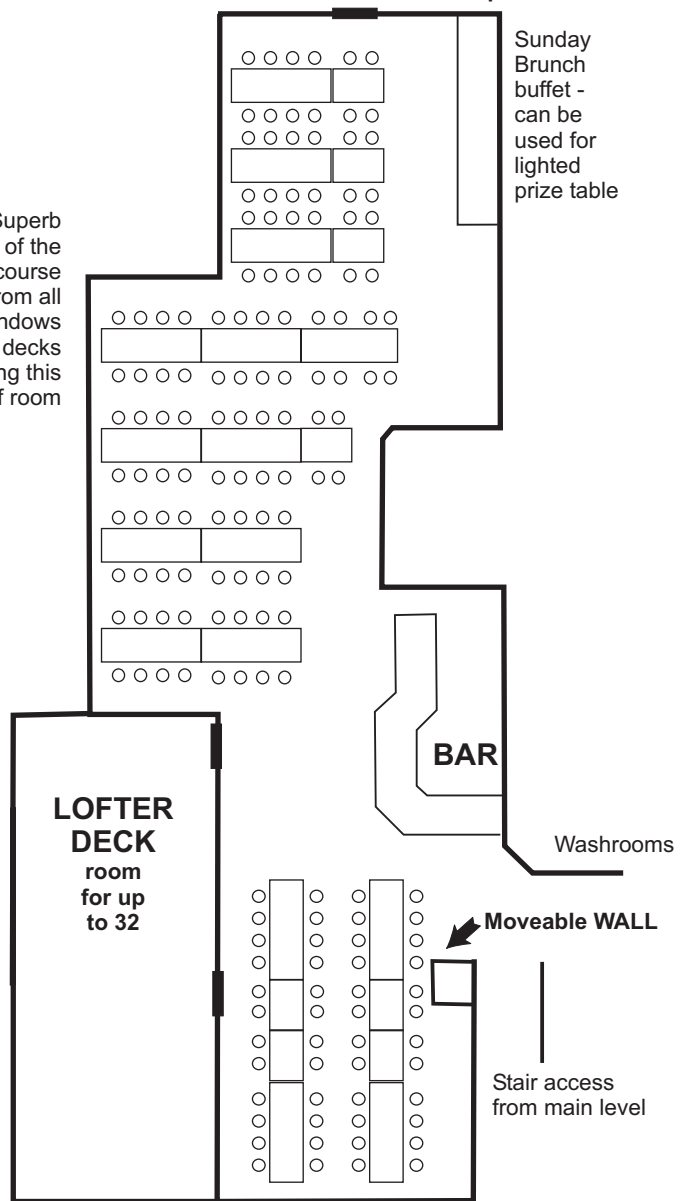

part of Brassie Room

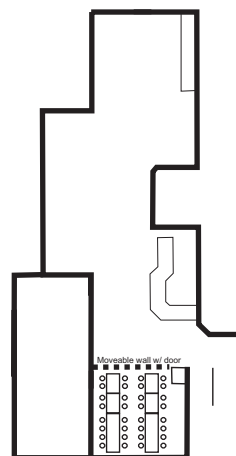

Duplex Room

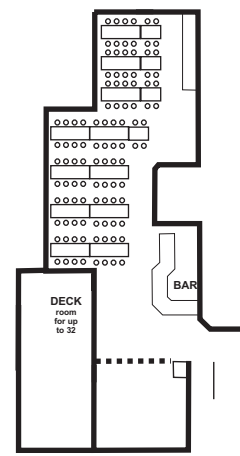

Brassie Room



(250) 765-4653  
GOLF  
www.KelownaSprings.com

